

FLAME

AVIATION



V7000 Brigade™
V7000 Brigade™ VIEW

V9000 Commander™
V9000 Commander™ XR

THE STANDARD IN CABIN FIRE + SMOKE TRAINERS

NEXT-GENERATION FIRE TRAINERS

1 Focus on lithium-ion battery fire training



Cabin fires are often caused by lithium-ion batteries.

Therefore this shall be trained realistically and intensively.

- Smartphone fire simulation
- Tablet fire simulation
- Laptop fire simulation
- Smoke functionalities
- Realistic glowing spots to cool down
- Automatic relight of the fire if not cooled down properly
- PED's are removable and can be stowed in any PED containment solution (XBAG, CellBlock, Fire Sock, PlaneGard, etc.)

2 Realistic training environment



Cabin crew shall have the skills, knowledge and confidence to deal with cabin fires.

Therefore, a training environment is created that triggers all senses and realistically simulates the circumstances of a real cabin fire incident, including:

- Real fire
- Heat
- Smoke (reduced visibility)
- Burning smell (XR)
- Cabin (panic) sound (XR)
- Glowing spots (laptop, waste bin)
- Hot spots (doors, luggage bins) (XR)

3 Measure training and log the performance



Fire training shall be structured and objectively measured.

Therefore pre-programmed fire training scenario's can be selected. This way, all trainees get presented the same training. To allow airlines to set their own proficiency standard, the level of difficulty is settleable from Level 1 up to 5.

Sensors are measuring the extinguishing performance and the result appears on the instructor station: "Passed" or "Failed".

This makes fire training objective, easy to log and transparent to the regulators.

FIRE TRAINER MODELS



V7000 Brigade™

- single-cabin fire trainer
- 9,0m x 2,5m (30ft x 8ft)
- 3 - 5 persons inside
- Installation inside or outside
- **Fires:** laptop, smartphone, oven, seat, luggage compartment, lavatory waste bin
- **Features:** Fire, heat, smoke, glowing spots, short-circuit effects, smoke detection



V7000 Brigade™ VIEW

- Single cabin version with large glass observation window
- Exclusively for inhouse installation.



V9000 Commander™

- Double-cabin fire trainer
- 9,0m x 2,5m (30ft x 8ft)
- 18 – 25 persons inside
- Installation outside or inside
- **Fires:** laptop, smartphone, oven, seat, luggage compartment, lavatory waste bin
- **Features:** Fire, heat, smoke, glowing spots, short-circuit effects, smoke detection



V9000 Commander™ XR

- **Additional features:** hot spots, cabin (panic) sound, burning smell

INTERIOR

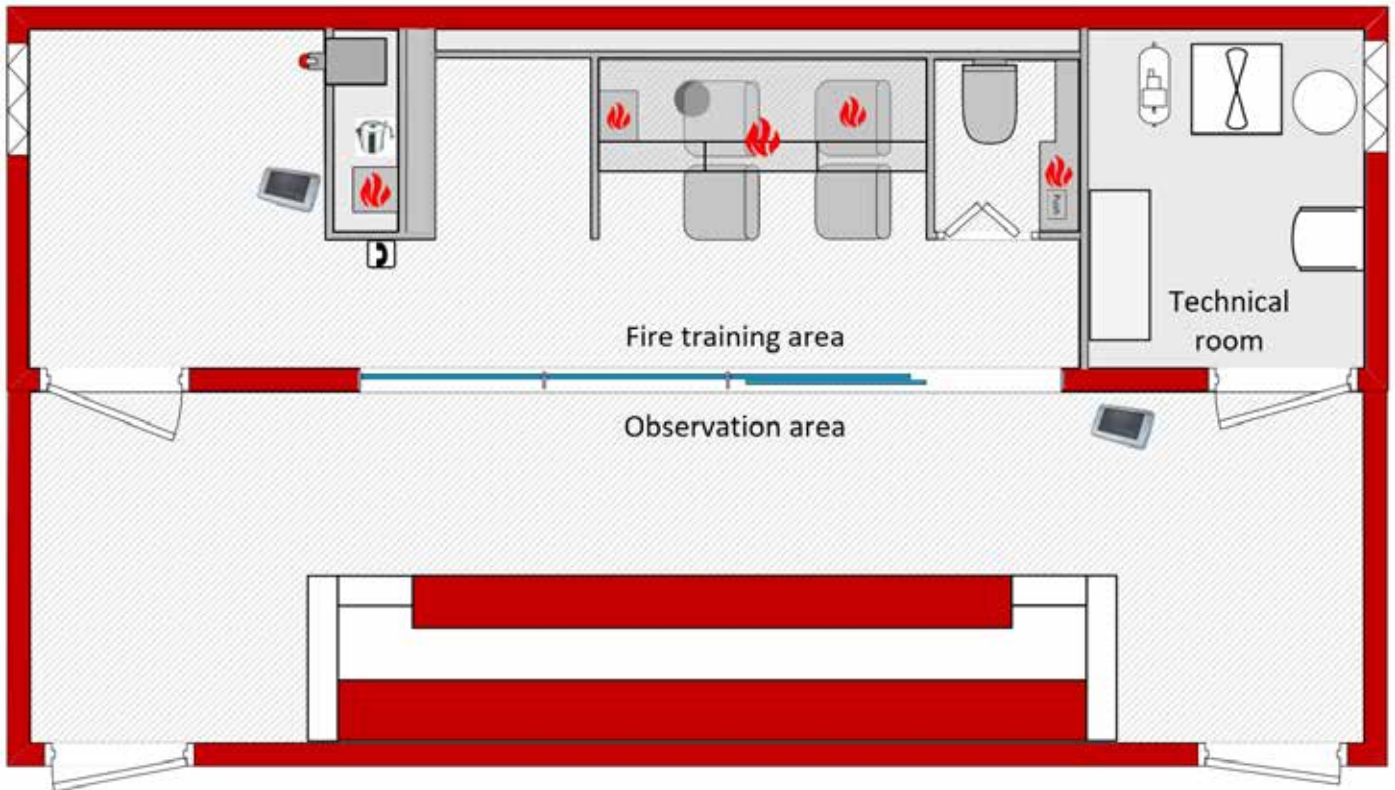

eXtreme Reality (XR): Top-3 cabin fires are caused by lithium-ion batteries. All fire trainers offer an extremely realistic training environment to provide cabin crew with the necessary knowledge, skills and confidence to deal with cabin fires.

Real fires, heat, smoke and glowing spots make sure all human senses are triggered.

The new V9000 Commander™ XR additionally offers hot spots in lavatory door and luggage bin, cabin sound, burning smells and other enhancing features to achieve **eXtreme Reality (XR)** in training!



INNOVATIONS



Dry-burner technology: Thanks to Flame Aviation's unique dry-burner technology, ignition is reliable and the burners provide a highly realistic flame picture.

Additionally, there is no black soot deposition like in old-generation fire trainers: **the fire trainer stays clean!**

To protect the automatic refilling station and to prevent calcium marks on the fire trainer interior, all models are equipped with a water filter and decalcifier unit.

Automatic refilling station: The fire trainer is equipped with a high-speed automatic refilling station. Fire extinguishers can be refilled within less than 20 seconds. (even if they have not been emptied)

The training fire extinguishers are made out of non-corroding stainless steel and can be used endlessly without the limitations of original fire extinguishers (original extinguishers have a limited number of permitted refilling cycles). **Available in red and chrome.**



INSTALLATION & TRAINING



Training

Flame Aviation will train customers' instructors and technicians. Additionally a complete fire training suite comes together with the fire trainer including:

- Fire training syllabus
- Fire training presentation
- Instructional video's

Required provisions

Required for the installation of the fire trainer are:

- Flat paved surface
- Electrical power
- Water connection
- Internet connection
- Natural gas bottle (LPG)



OUR CREDENTIALS

Over 25 flag-carriers, LCC's and training centers have chosen for Flame Aviation's fire trainers in the last three years. Selecting Flame Aviation' Next-Generation fire trainer means:

- Most sophisticated fire trainers available
- Extensive experience and proven quality
- Unprecedented track record

2017



2018



2019



Flame Aviation is the world's leading manufacturer of the next-generation cabin fire + smoke trainers for airlines and training centers.

It is offering innovative fire training solutions, has the fastest growing fire trainer installed-base and is offering a world-class customer support organization.

■■■ FLAME ■■■
A V I A T I O N

Mees Toxopeüsstraat 3a • 2315 WD Leiden • The Netherlands
+31 630 121679 • info@flame-aviation.com • www.flame-aviation.com